

1 WiFi Stick Installation

Step 1:
Plug the Smart WiFi 2.0 into WiFi/GPRS port under the bottom (underside) of the inverter.
Note: label face to front.

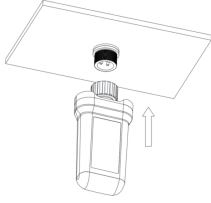

Step 2:
Tighten the nut clockwise as following.

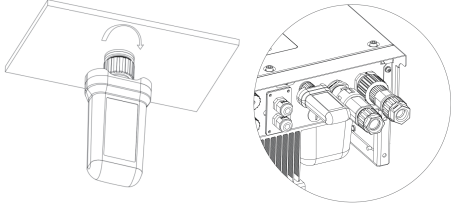

Step 3:
Power on the inverter (in accordance with the start-up procedure detailed in the inverter installation manual).

- Note:**
- For Brasil: Regulamento Anatel sobre equipamentos de Radiocomunicação de Radiação Restrita (Resolução nº 680): "Este equipamento não tem direito à proteção contra interferência prejudicial e não pode causar interferência em sistemas devidamente autorizados".
 - Warning: This is a class A Product. In a domestic environment this product may cause radio interference in which case the user may be required to take adequate measures.
 - Products exported to Brasil have obtained ANATEL certification, and the following signs will be placed on the shell.



14599-20-13382

2 APP Installation

Scan the QR Code below to download and install the FoxCloud APP on your smartphone.



3 Configuration

Step 1:
Connect your mobile device with Smart WiFi. The SSID of the Smart WiFi is 'W-xxxxx' and the password is 'mmt2020'.

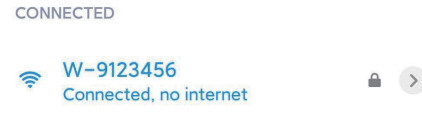

Step 2:
After connecting successfully. Open browser and enter '192.168.1.1' on the address bar on top.

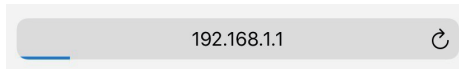

Step 3:
Drop down the WiFi SSID menu to find house router and input the house router's password. Click 'Save'.

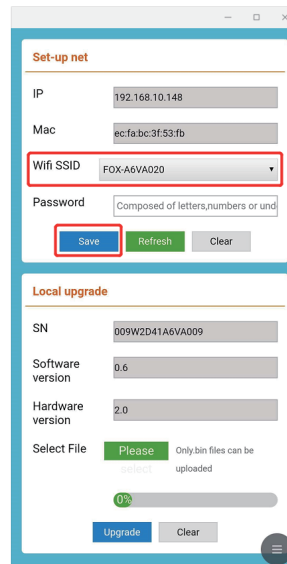

4 Register An Account

For Installer

Step 1:
Please click 'Sign Up', enter installer's information to complete the installer account registration.
Note: If you already have an installer/agent account, please press 'Sign In' and enter with your installer/agent account directly.

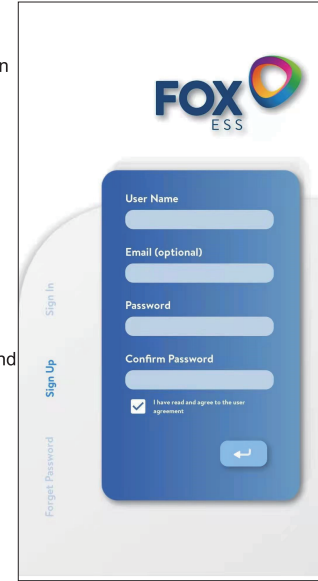

Step 2:
Select 'Installer' and enter Installer name, then click 'OK'. We suggest you complete all information to ensure after-sales service.
Note:
Installer: The installer
Agent: The agent/distributor/installation company.

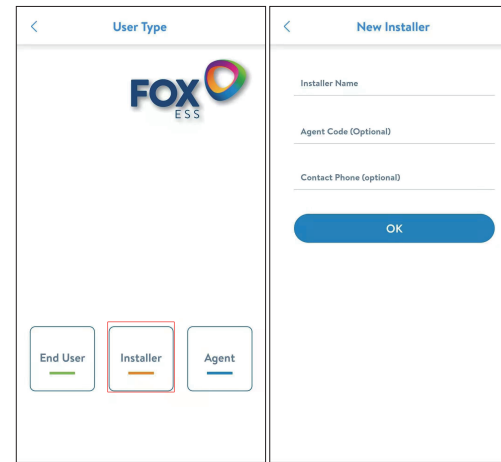

For End User

Step 1:
Please click 'Sign Up', enter end user's information to complete the end user account registration.

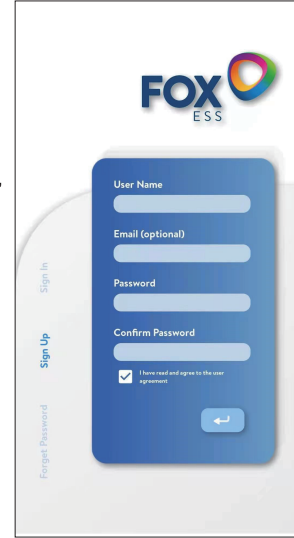

Step 2:
Select 'End User' then scan the WiFi bar code on the Smart WiFi, and click 'OK'. We suggest you complete all information to ensure after-sales service.

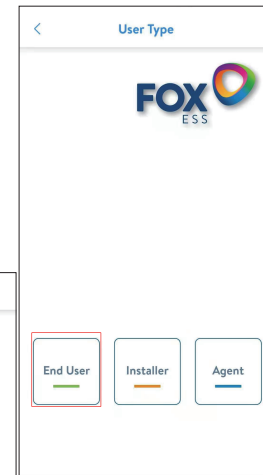
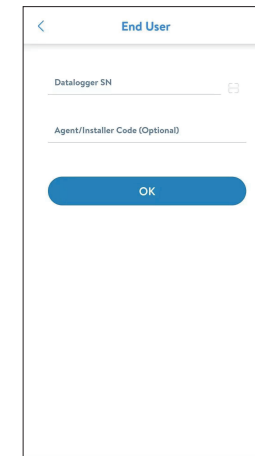

5

Create A Plant



For Installer

Step 1:
Open the APP,
login with your
Installer/agent
account.



Step 2:
Press the '+' icon on
the homepage to add
plant. Press the scan
icon next to the
'Datalogger List' to
scan the QR code label
on front side of the
Smart WiFi.

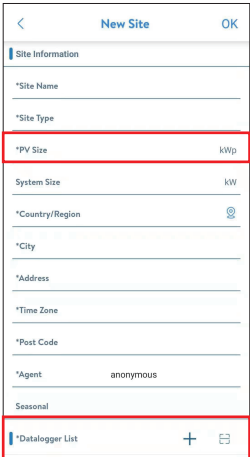

Note: After starting the APP, it will pop-up a message 'Whether to allow positioning permissions', please select 'Allow'. For the PV Size, please fill in the actual capacity of the installed solar panels.

For End User

Step 1:
Open the APP,
login with your
end user account.

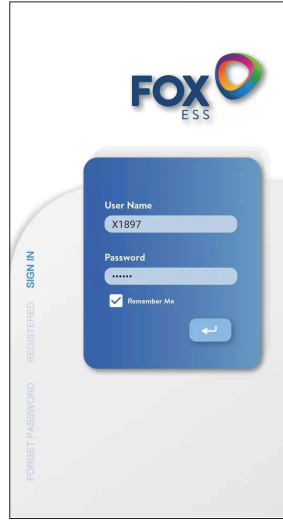

Step 2:
Press the '+' icon on
the homepage to add
plant. Press the scan
icon next to the
'Datalogger List' to
scan the QR code label
on front side of the
Smart WiFi.

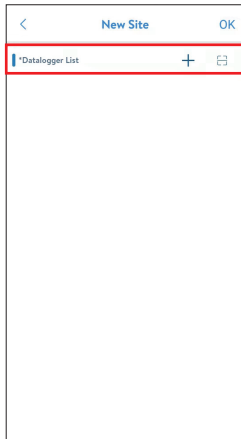

Note: After starting the APP, it will pop-up a message 'Whether to allow positioning permissions', please select 'Allow'. For the PV Size, please fill in the actual capacity of the installed solar panels.

Note: If SN has been bound to the plant already, APP will go to the page as beside. If SN has not been bound before, please refer to step 3.



Step 3:
After scanning code successfully, click 'OK' on the top right corner of the page, APP will pop-up a message 'Add Datalogger', please click 'OK'. Complete all required information and click 'OK' on the top right corner of the page.

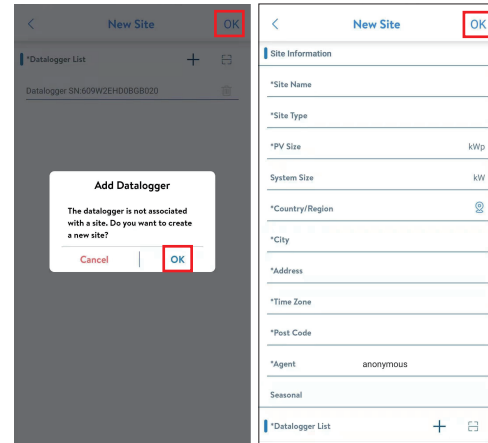

The manual is updated frequently. Please scan the code to download the latest version.