

Quick Installation Guide

1. Tools Required

The following tools will be required to install EQ-M (Master module) and EQ-S (Slave module), includes heated and unheated versions.



2. Packing List

For EQ-S:

No.	Items
A	Mounting screw pack
B	Installation guide

For EQ-M:

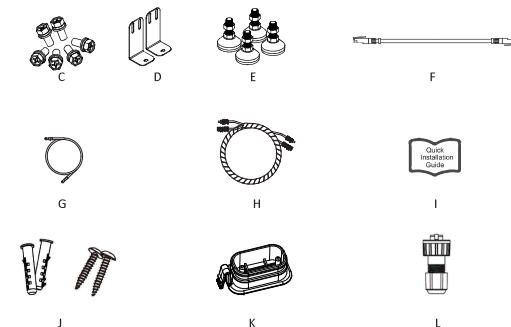

No.	Items	No.	Items
C	Mounting screw pack	H	DC output cable
D	Fixing bracket	I	Installation guide
E	Footstand	J	Expansion tube*2 & Expansion screw*2
F	Communication cable (BMS-inverter)	K	Waterproof cover
G	Grounding cable	L	RJ45

Note: For heated and unheated versions, K is different.

3. Terminals

For EQ-S:

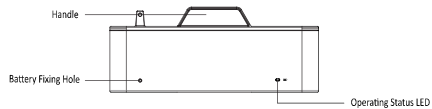

For EQ-M:

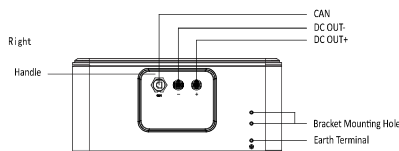
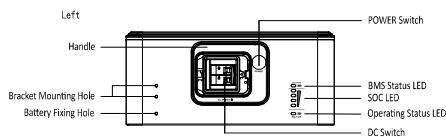

4. Installation Steps

Step 1

Install a EQ-S with four footstand (Item E) and place it on the ground and adjust it to the level. After installing the footstand, use a track level bar to confirm the level. Insert the waterproof cover (Item K) into the bottom of the battery and lock it in place with the clip.

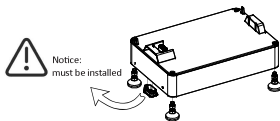

Step 2

Place the battery 20mm against the wall. Note: Please make sure the Operating Status LED is on your left handside when you facing the battery model.

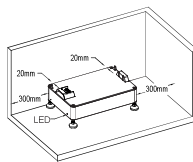

Step 3

Stack the batteries one by one.

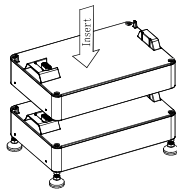

Step 4

Place the two fixing brackets (Item D) close to the wall and install them on both sides of the battery.

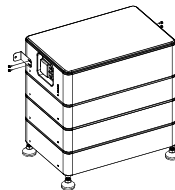

Step 5

Mark the wall through the bracket hole.

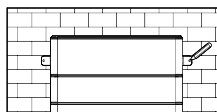

Step 6

Punch after removing the EQ-M. Drill holes with electric drill, make sure the holes are at least 50mm deep, and then tighten the expansion tubes (Item J).

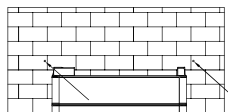

Step 7

After stacking EQ-M again, fix the battery on the wall.

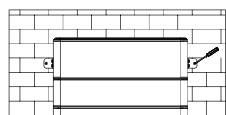

Step 8

Fix the mounting screw packs on both sides of the battery, the installation is over.

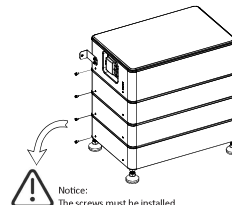

Note: Please make sure each system including 1 EQ-M and 1 EQ-S. EQ-S less than 6(1~6) pieces:

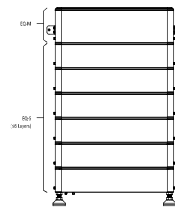

Note: When used with an inverter, the battery system voltage must meet the inverter battery port voltage range.

5. Wiring Steps

A: Connect the inverter and make sure the wiring position is correct, as shown in the figure below.

Note: Inverter wiring refer to the inverter user manual.

For outdoor use, please use Item L and proceed as follows

Connection steps:

Step 1: Prepare a standard network cable and cable connector, then insert the network cable through the cable connector.

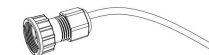

Step 2: Crimp the cable with a RJ45 plug which is inside of the cable connector.

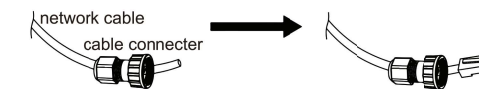

Rj45 plug

If the usage is indoor, please use Item F

Step 3: Insert the cable connector into BMS port at the bottom of inverter and screw it tightly.

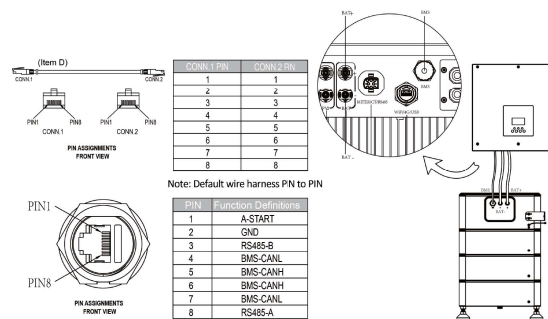

B: Connect the grounding cable. The figure is shown in below.

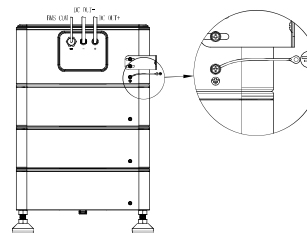

6. System Operation

System Start Up:

When the inverter is connected to the PV and the grid and both are operating normally, turn on the battery DC Switch. Press the POWER Switch and hold it for 3 seconds, then release. The Status LED is blinking green and indicates that the system is working normally.

System Shut Down:

Press and hold the POWER switch for at least 5 seconds until all of the Master LEDs (BMS Status LED and SOC LED) begin blinking. Once they start blinking, release the switch. The lights will automatically turn off after 5 seconds. Then, turn off the DC switch.

System Black Start:

Under special circumstances when both PV and Grid power are out of order, the battery can be activated through the "Black Start" function. This means that our energy storage inverter and battery can continue to operate. The startup steps for black start are as follows:

- Turn on the DC switch, press and hold the power button for 3 seconds, then release.
- Press the "Power Switch" button three times in succession within 4 seconds (Complete within 30 seconds after the battery system starts up).
- The Status LED remains solid green, indicating successful activation of Black start mode.

Note: Ensure correct battery-inverter connection prior to Black Start. No wiring modifications during black start.

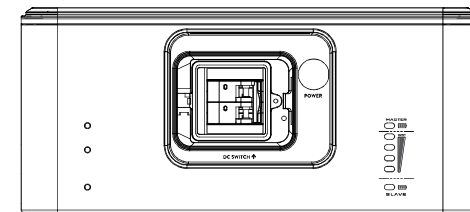

Please scan the QR Code and follow the steps below to download our latest multi-language User Manual/Quick Installation Guide:

Scan the QR Code → Select your Language → Choose to download User Manual or Quick Installation Guide → Download

